

+NOTICE!!

These documents have been scanned!

Do not place un-scanned documents beneath this notice!

Do not remove this notice from this file!

GPO Jacket No. 560-102
Print Order 61549
Rise Business Services, LLC
Job=AZ15 1/8/2020



Box Number= AZ15284



Claim Begin-End: AMC458304-AMC458308

1 Initial Receipt



AZ15284-33

AMC458525-AMC458783

United States Department of the Interior
Bureau of Land Management
 DIV OF LANDS, MINRLS & ENERGY
 ONE N CENTRAL AVE
 PHOENIX, AZ 85004 -4427
 Phone: 602-417-9200

Receipt	
No:	4618163

Transaction #: 4740396
Date of Transaction: 11/27/2019

CUSTOMER:	
FRED DICKINSON 7815 W ROCK SPRINGS DR PEORIA,AZ 85383-6208 US	

LINE #	QTY	DESCRIPTION	REMARKS	UNIT PRICE	TOTAL
1	5.00	LOCATABLE MINERALS / MINING CLAIMS-NEW,UNADJUD, ONE OR MORE AUTH NOS / NEW MINING CLAIM PROCESSING FEE CASES: AMC458304/\$20.00, AMC458305/\$20.00, AMC458306/\$20.00, AMC458307/\$20.00, AMC458308/\$20.00		- n/a -	100.00
2	5.00	LOCATABLE MINERALS / MINING CLAIMS-NEW,UNADJUD, ONE OR MORE AUTH NOS / NEW MINING CLAIMS LOCATION FEE CASES: AMC458304/\$40.00, AMC458305/\$40.00, AMC458306/\$40.00, AMC458307/\$40.00, AMC458308/\$40.00		- n/a -	200.00
3	5.00	LOCATABLE MINERALS / MINING CLAIMS-NEW,UNADJUD, ONE OR MORE AUTH NOS / NEW MINING CLAIMS MAINTENANCE FEE CASES: AMC458304/\$165.00, AMC458305/\$165.00, AMC458306/\$165.00, AMC458307/\$165.00, AMC458308/\$165.00		- n/a -	825.00
TOTAL:					\$1,125.00

PAYMENT INFORMATION

NOTE: Items will appear on credit card statement as "Bureau of Land Mgmt CO".

1	AMOUNT:	800.00	POSTMARKED:	N/A
	TYPE:	CREDIT CARD	RECEIVED:	11/27/2019
	NAME:	DICKINSON, FRED 7815 W ROCK SPRINGS DR PEORIA AZ 85383-6208 US		
	CARD NO:	XXXXXXXXXXXX3310	AUTH CODE:	00382Z

ENTERED
 DEC 05 2019
 BY: *RAM*

	NAME ON CARD:	FRED W DICKINSON	
	SIGNATURE:		
2	AMOUNT:	325.00	POSTMARKED: N/A
	TYPE:	CREDIT CARD	RECEIVED: 11/27/2019
	NAME:	DICKINSON, FRED 7815 W ROCK SPRINGS DR PEORIA AZ 85383-6208 US	
	CARD NO:	XXXXXXXXXXXX8936	AUTH CODE: 027985
	NAME ON CARD:	FRED DICKINSON	
	SIGNATURE:		

REMARKS

This receipt was generated by the automated BLM Collections and Billing System and is a paper representation of a portion of the official electronic record contained therein.

NOTICE!!

These documents have been scanned!

Do not place un-scanned documents beneath this notice!

Do not remove this notice from this file!

GPO Jacket No. 560-102
Print Order 61549
Rise Business Services, LLC
Job=AZ15 1/8/2020



Box Number= AZ15284



Claim Begin-End: AMC458304-AMC458308

2 Correspondence



AZ15284-33

AMC458525-AMC458783

**NO
DOCUMENTS
FOUND**

NO DOCUMENTS FOUND
NO DOCUMENTS FOUND

NOTICE!!

These documents have been scanned!

Do not place un-scanned documents beneath this notice!

Do not remove this notice from this file!

GPO Jacket No. 560-102
Print Order 61549
Rise Business Services, LLC
Job=AZ15 1/8/2020



Box Number= AZ15284



Claim Begin-End: AMC458304-AMC458308

3 Transfers



AZ15284-33

AMC458525-AMC458783

**NO
DOCUMENTS
FOUND**

NO DOCUMENTS FOUND
NO DOCUMENTS FOUND

NOTICE!!

These documents have been scanned!

Do not place un-scanned documents beneath this notice!

Do not remove this notice from this file!

GPO Jacket No. 560-102
Print Order 61549
Rise Business Services, LLC
Job=AZ15 1/8/2020



Box Number= AZ15284



Claim Begin-End: AMC458304-AMC458308

4 Annual Filings



AZ15284-33

AMC458525-AMC458783

**NO
DOCUMENTS
FOUND**

NO DOCUMENTS FOUND
NO DOCUMENTS FOUND

NOTICE!!

These documents have been scanned!

Do not place un-scanned documents beneath this notice!

Do not remove this notice from this file!

GPO Jacket No. 560-102
Print Order 61549
Rise Business Services, LLC
Job=AZ15 1/8/2020



Box Number= AZ15284



Claim Begin-End: AMC458304-AMC458308

5 Miscellaneous



AZ15284-33

AMC458525-AMC458783

**NO
DOCUMENTS
FOUND**

NO DOCUMENTS FOUND
NO DOCUMENTS FOUND

NOTICE!!

These documents have been scanned!

Do not place un-scanned documents beneath this notice!

Do not remove this notice from this file!

GPO Jacket No. 560-102
Print Order 61549
Rise Business Services, LLC
Job=AZ15 1/8/2020



Box Number= AZ15284



Claim Begin-End: AMC458304-AMC458308

6 Location Notices-Amendments and Supporting Documents



AZ15284-33

AMC458525-AMC458783

MINING CLAIM STATUS REPORT

Data Entered: 12/5/19 RAM

MTP Checked By: 12/5/19 RAM

GEO Checked By: 12/5/19 RAM

LEAD SERIAL NUMBER: AMC 458304 thru AMC 458309

NUMBER OF CLAIMS & TYPE:

CHARGES:

LODE _____
5 PLACER _____
ASSOCIATION PLACER _____
MILL SITE _____
TUNNEL SITE _____

Processing Fee @ \$20 = \$ 100
Location Fee @ \$40 = \$ 200
Maintenance Fee @ \$165 = \$ 825
Add'l Maint Fee for Assoc Placer = \$ _____
SUBTOTAL \$ 1125

TOTAL ACREAGE: 20 Per Claim
(Placer Only)

Other Fees \$ _____
Other Fees \$ _____
TOTAL \$ _____

NUMBER OF LOCATORS: 1

DOCUMENTS RECEIVED VIA : Over-the-Counter Mail **TIMELY FILED:** Yes No

LEGAL DESCRIPTION: T 9N R 5W SEC 13
T _____ R _____ SEC _____
T _____ R _____ SEC _____
T _____ R _____ SEC _____
T _____ R _____ SEC _____

BLM FOREST SERVICE _____ SUBJ TO PL 359: Yes No
WILDERNESS AREA _____

SPLIT ESTATE: N/A SX PX OTHER _____
SRHA Was proper Notice filed if located on SHRA Land? Yes No

RECONVEYED MINERALS ON BLM LAND REQUIRE OPENING ORDER FROM 1944 TO 1993:

Open to Entry On _____ N/A

COMMENTS/STATUS: VOID PARTIALLY VOID PVT MINERALS WITHDRAWN LANDS
OTHER _____

[] Claimant acknowledges that portions of the following claim(s) site(s) may be void or voidable.

Printed Name of Claimant _____ Signature of Claimant _____

*****FINAL ADJUDICATION*****

DATE _____ INITIALS _____

Return to: Fred Dickinson
7815 W. Rock Springs Dr., Peoria, AZ 85383

LOCATION NOTICE FOR PLACER MINING CLAIM

Amendment BLM Serial # _____

NOTICE IS HEREBY GIVEN that the **Little Picker East** placer mining claim has been located by **Fred Dickinson** whose current mailing address is:
7815 W. Rock Springs Dr., Peoria, AZ 85383

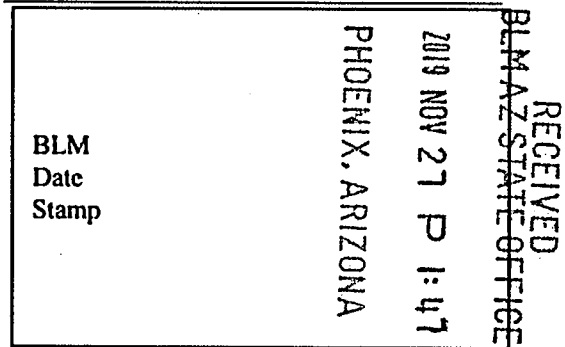

The general course of this claim is **North to South** and it is situated in **Yavapai** County, Arizona. This claim is **1320** feet in length and **660** feet in width.

20 Acres Total Claim Acreage. This claim runs from the location monument on which this location notice is posted at the **NE** corner of the claim approximately **1320** feet in a **South** direction from the **North** end line and **660** feet in a **West** direction from the **East** end line. This claim is marked by four monuments, one at each corner of the claim. The location monument on which this notice is posted is situated within Section **13**, Township **9N**, Range **5W**, Gila Salt River Base and Meridian, Arizona. This claim encompasses portions of the following legal subdivision(s) if located by legal subdivision or the following quarter section(s), section(s), Township(s) and Range(s) **East 1/2 of the NE 1/4 of the NE 1/4 of Sec. 13, T9N, R5W**, Gila Salt River Base and Meridian, Arizona. The locality of this claim with reference to some natural object or permanent monument and additional information (if any) concerning its locality are as follows: **The NE corner of the claim is the NE Corner of Sec 13, T9N, R5W.**

The above information is shown on the attached map. DATED AND POSTED on the ground this **1st** day of **September, 2019**.

Locators:

Printed Name Fred Dickinson Signature(s) 

Address: **7815 W. Rock Springs Dr., Peoria, AZ 85383**

AMC 458304

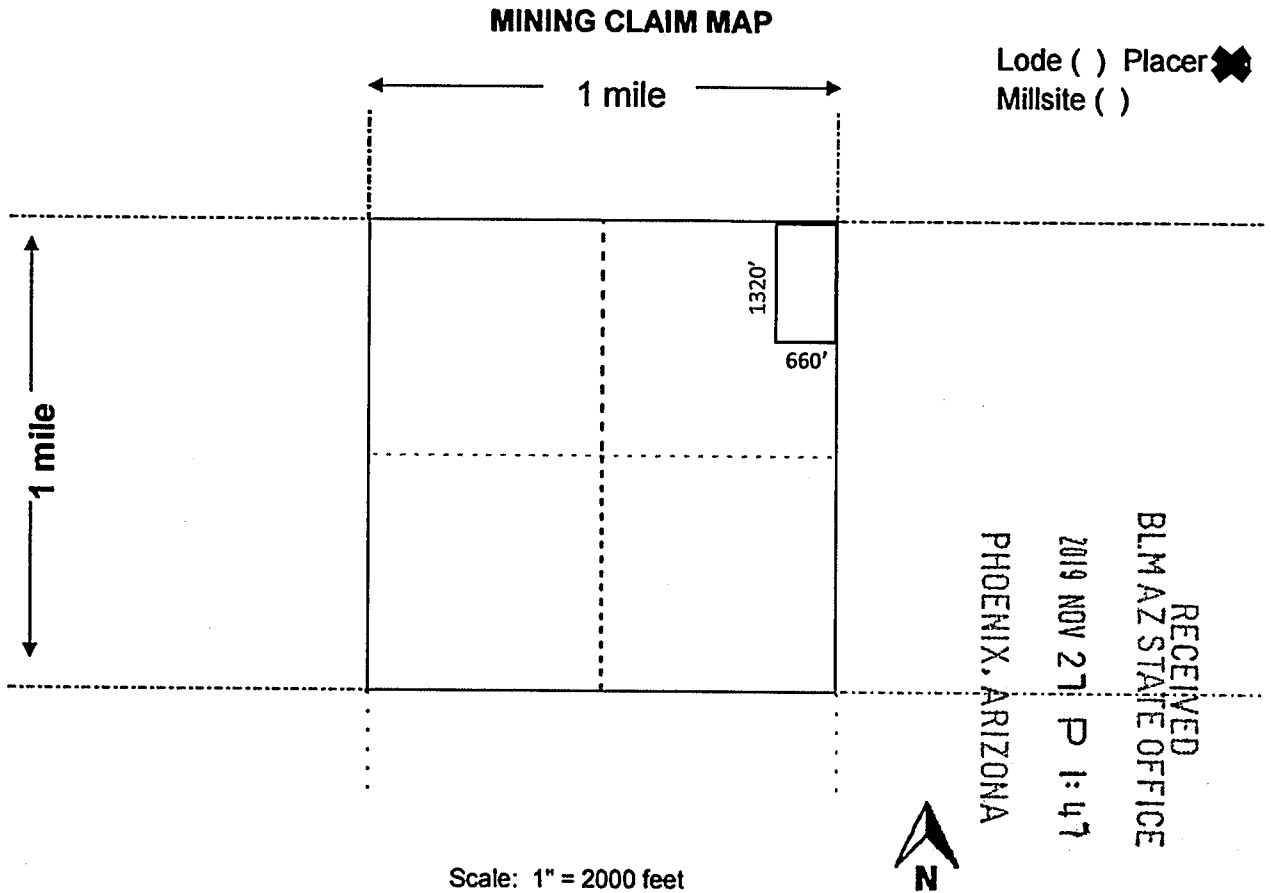

1. The above map depicts the **Little Picker East** mining claim, which is located in Section(s) **13**, Township **9N**, Range **5W**, Gila and Salt River Base and Meridian, **Yavapai** County, Arizona.

Total claim acreage is **20 Acres**.

2. The type of corner and location monuments used are as follows: **Capped PVC, Standing >5' tall.**

3. The bearings and distances in degrees and feet between claim corners and to a public land survey monument are as depicted on the map. **The NE corner of the claim is the NE Corner of Sec 13, T9N, R5W.**

4. If the claim is a placer or millsite claim with exterior limits conforming to legal subdivisions of the public survey, provide a legal description of the claim **East ½ of the NE ¼ of the NE ¼ of Sec. 13 T9N R5W of the Gila and Salt River Base and Meridian, Yavapai County, Arizona.**

AMC 458304

Return to: Fred Dickinson
7815 W. Rock Springs Dr., Peoria, AZ 85383

LOCATION NOTICE FOR PLACER MINING CLAIM

Amendment BLM Serial # _____

NOTICE IS HEREBY GIVEN that the **Little Picker**
West placer mining claim has been located by **Fred**
Dickinson whose current mailing address is:

7815 W. Rock Springs Dr., Peoria, AZ
85383

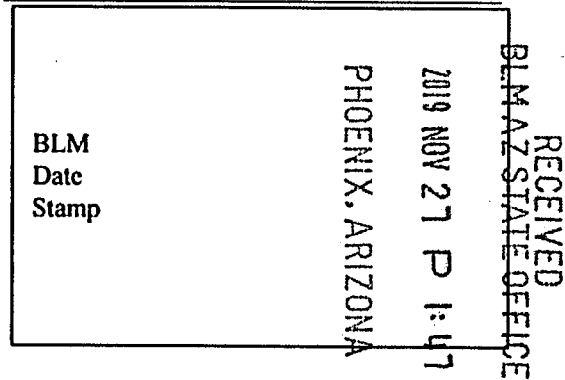

The general course of this claim is **North to South** and it is situated in **Yavapai** County, Arizona. This claim is **1320** feet in length and **660** feet in width.

20 Acres Total Claim Acreage. This claim runs from the location monument on which this location notice is posted at the **NE** corner of the claim approximately **1320** feet in a **South** direction from the **North** end line and **660** feet in a **West** direction from the **East** end line. This claim is marked by four monuments, one at each corner of the claim. The location monument on which this notice is posted is situated within Section **13**, Township **9N**, Range **5W**, Gila Salt River Base and Meridian, Arizona. This claim encompasses portions of the following legal subdivision(s) if located by legal subdivision or the following quarter section(s), section(s), Township(s) and Range(s) **West 1/2 of the NE 1/4 of the NE 1/4 of Sec. 13, T9N, R5W**, Gila Salt River Base and Meridian, Arizona. The locality of this claim with reference to some natural object or permanent monument and additional information (if any) concerning its locality are as follows: **The NE corner of the claim is 660' West of the NE Corner of Sec 13, T9N, R5W.**

The above information is shown on the attached map. DATED AND POSTED on the ground this **1st** day of **September, 2019**.

Locators:

Printed Name Fred Dickinson

Signature(s) _____

Address: **7815 W. Rock Springs Dr., Peoria, AZ 85383**

AMC 458305

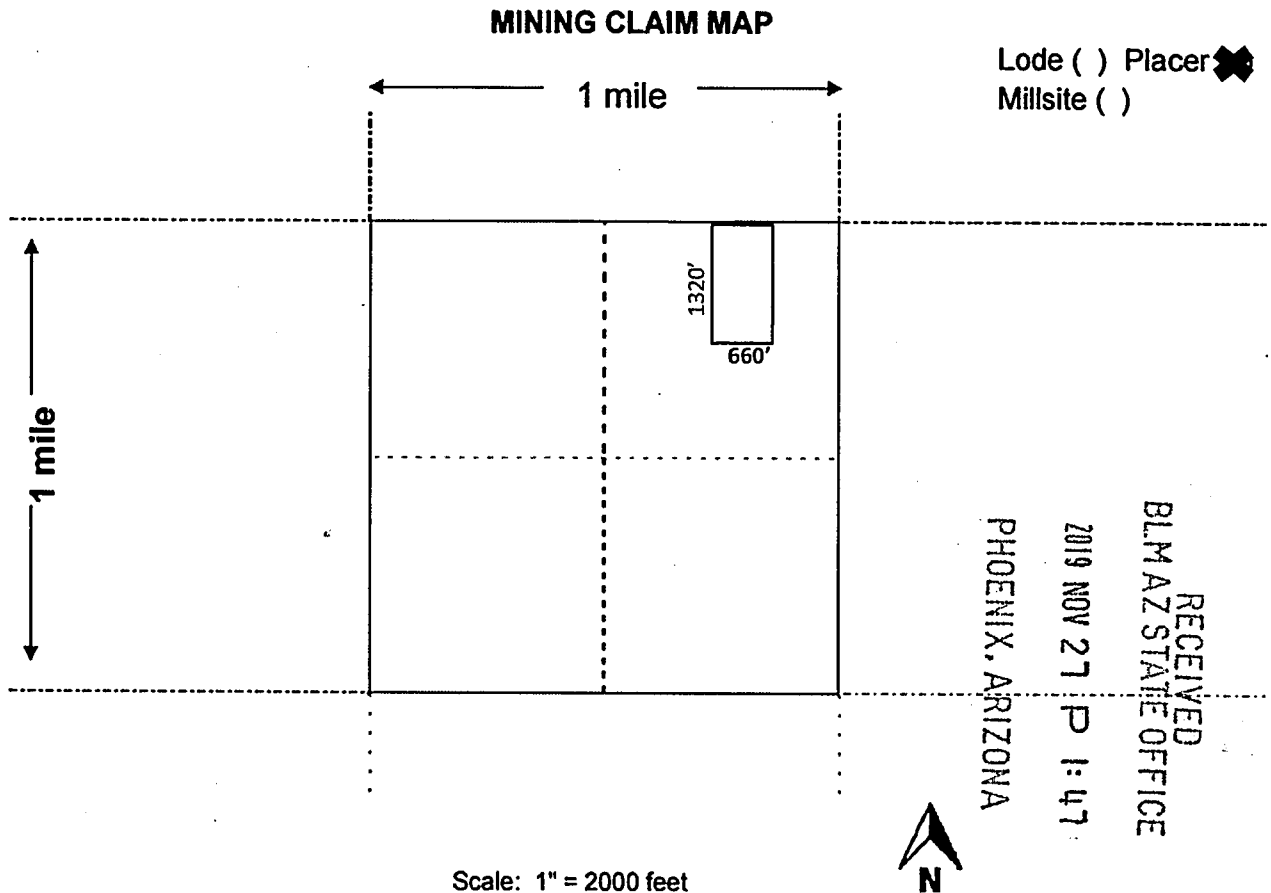

1. The above map depicts the **Little Picker West** mining claim, which is located in Section(s) **13**, Township **9N**, Range **5W**, Gila and Salt River Base and Meridian, **Yavapai** County, Arizona.

Total claim acreage is **20 Acres**.

2. The type of corner and location monuments used are as follows: **Capped PVC, Standing >5' tall.**

3. The bearings and distances in degrees and feet between claim corners and to a public land survey monument are as depicted on the map. **The NE corner of the claim is 660' West of the NE Corner of Sec 13, T9N, R5W.**

4. If the claim is a placer or millsite claim with exterior limits conforming to legal subdivisions of the public survey, provide a legal description of the claim **West ½ of the NE ¼ of the NE ¼ of Sec. 13 T9N R5W of the Gila and Salt River Base and Meridian, Yavapai County, Arizona.**

AMC 458305

Return to: Fred Dickinson
7815 W. Rock Springs Dr., Peoria, AZ 85383

LOCATION NOTICE FOR PLACER MINING CLAIM

Amendment BLM Serial # _____

NOTICE IS HEREBY GIVEN that the Little Picker
South placer mining claim has been located by Fred
Dickinson whose current mailing address is:

7815 W. Rock Springs Dr., Peoria, AZ
85383

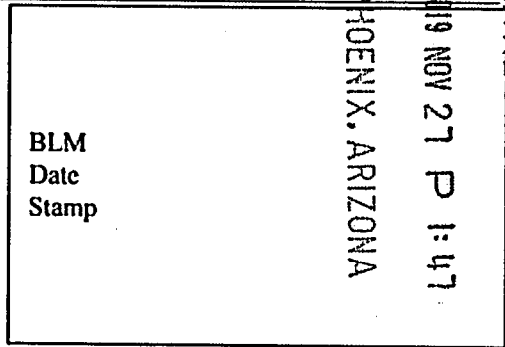

The general course of this claim is North to South and it is situated in Yavapai County, Arizona.
This claim is 1320 feet in length and 660 feet in width.

20 Acres Total Claim Acreage. This claim runs from the location monument on which this location notice is posted at the NE corner of the claim approximately 1320 feet in a South direction from the North end line and 660 feet in a West direction from the East end line. This claim is marked by four monuments, one at each corner of the claim. The location monument on which this notice is posted is situated within Section 13, Township 9N, Range 5W, Gila Salt River Base and Meridian, Arizona. This claim encompasses portions of the following legal subdivision(s) if located by legal subdivision or the following quarter section(s), section(s), Township(s) and Range(s) NE ¼ of the NE ¼ of Sec. 13, T9N, R5W, Gila Salt River Base and Meridian, Arizona. The locality of this claim with reference to some natural object or permanent monument and additional information (if any) concerning its locality are as follows: The NE corner of the claim is 1320' South of the NE Corner of Sec 13, T9N, R5W.

The above information is shown on the attached map. DATED AND POSTED on the ground this 1st day of September, 2019.

Locators:

Printed Name Fred Dickinson Signature(s) _____

Address: 7815 W. Rock Springs Dr., Peoria, AZ 85383

AMC 458306

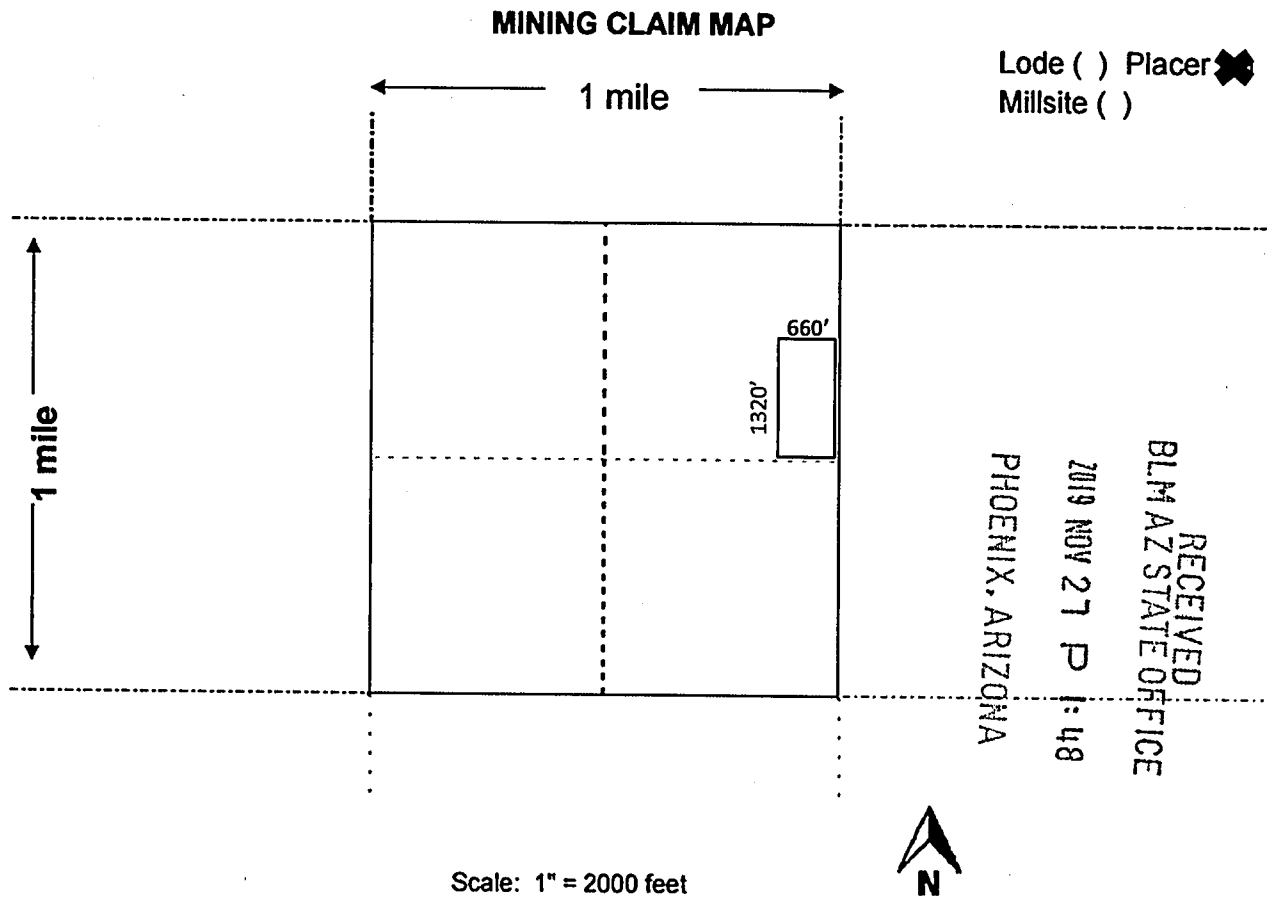

1. The above map depicts the **Little Picker South** mining claim, which is located in Section(s) **13**, Township **9N**, Range **5W**, Gila and Salt River Base and Meridian, **Yavapai** County, Arizona.

Total claim acreage is **20 Acres**.

2. The type of corner and location monuments used are as follows: **Capped PVC, Standing >5' tall.**

3. The bearings and distances in degrees and feet between claim corners and to a public land survey monument are as depicted on the map. **The NE corner of the claim is 1320' South of the NE Corner of Sec 13, T9N, R5W.**

4. If the claim is a placer or millsite claim with exterior limits conforming to legal subdivisions of the public survey, provide a legal description of the claim **E ½ of the SE ¼ of the NE ¼ of Sec. 13 T9N R5W of the Gila and Salt River Base and Meridian, Yavapai County, Arizona.**

AHC458306



*Return to: Fred Dickinson
7815 W. Rock Springs Dr.
Peoria, AZ 75383

LOCATION NOTICE FOR PLACER MINING CLAIM

Amendment BLM Serial # _____

NOTICE IS HEREBY GIVEN that the **Dickinson #2** placer mining claim has been located by **Fred Dickinson** whose current mailing address is:
7815 W. Rock Springs Dr., Peoria, AZ 85383

RECEIVED
BLM AZ STATE OFFICE
2019 NOV 27 P 1:48
PHOENIX, ARIZONA
BLM
Date
Stamp

The general course of this claim is **East to West** and it is situated in **Yavapai** County, Arizona. This claim is **660** feet in length and **1320** feet in width.

20 Acres Total Claim Acreage. This claim runs from the location monument on which this location notice is posted at the **SE** corner of the claim approximately **1320** feet in a **North** direction from the **South** end line and **660** feet in a **West** direction from the **East** end line. This claim is marked by four monuments, one at each corner of the claim. The location monument on which this notice is posted is situated within Section **13**, Township **9N**, Range **5W**, Gila Salt River Base and Meridian, Arizona. This claim encompasses portions of the following legal subdivision(s) if located by legal subdivision or the following quarter section(s), section(s), Township(s) and Range(s) **N 1/2 of the SW 1/4 of the NE 1/4 of Sec. 13, T9N, R5W**, Gila Salt River Base and Meridian, Arizona. The locality of this claim with reference to some natural object or permanent monument and additional information (if any) concerning its locality are as follows: **The NW corner of the claim is located 2640' North and 660' West of the Center of Sec 13, T9N, R5W.**

The above information is shown on the attached map. DATED AND POSTED on the ground this **1st** day of **September**, 20**19**.

Locators:

Printed Name Fred Dickinson Signature(s)

Address: 7815 W. Rock Springs Dr., Peoria, AZ 85383

AMC458307

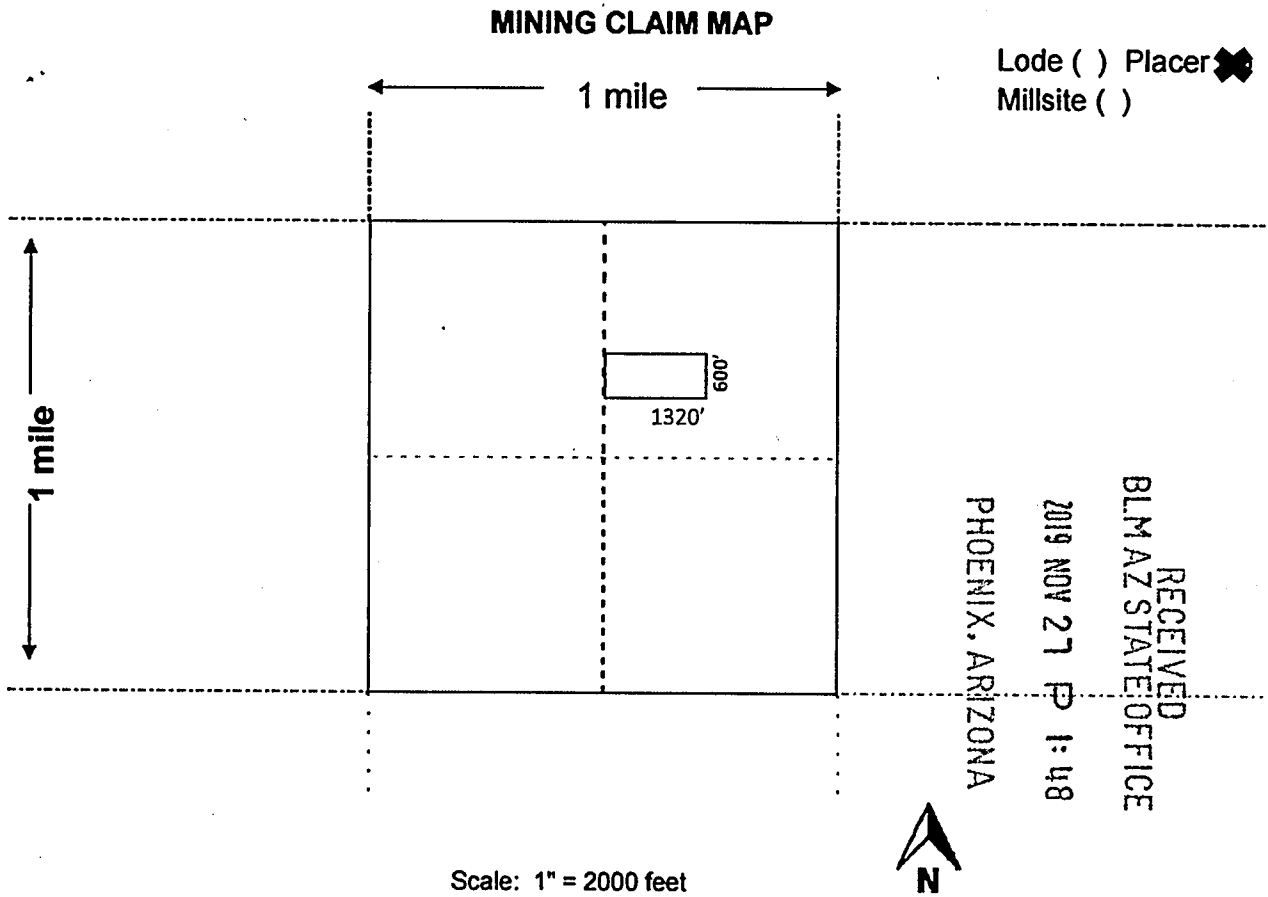

1. The above map depicts the **Dickinson #2** mining claim, which is located in Section(s) **13**, Township **9N**, Range **5W**, Gila and Salt River Base and Meridian, **Yavapai** County, Arizona.

Total claim acreage is **20 Acres**.

2. The type of corner and location monuments used are as follows: **2" Capped PVC, Standing 5' tall.**

3. The bearings and distances in degrees and feet between claim corners and to a public land survey monument are as depicted on the map. **The NW corner of the claim is located 2640' North and 660' West of the Center of Sec 13, T9N, R5W..**

4. If the claim is a placer or millsite claim with exterior limits conforming to legal subdivisions of the public survey, provide a legal description of the claim **The South ½ of the SW ¼ of the NE ¼ of Sec 13, T9N, R5W.of the Gila and Salt River Base and Meridian, Yavapai County, Arizona.**

AMC458307



*Return to: Fred Dickinson
7815 W. Rock Springs Dr.
Peoria, AZ 75383

LOCATION NOTICE FOR PLACER MINING CLAIM

Amendment BLM Serial # _____

NOTICE IS HEREBY GIVEN that the **Dickinson #3**
placer mining claim has been located by **Fred**
Dickinson whose current mailing address is:

7815 W. Rock Springs Dr., Peoria, AZ
85383

BLM Date Stamp	2019 NOV 27 P 1:48 PHOENIX, ARIZONA
----------------------	--

RECEIVED
BLMAZ STATE OFFICE

The general course of this claim is **North to South** and it is situated in **Yavapai** County, Arizona.
This claim is **660** feet in length and **1320** feet in width.

20 Acres Total Claim Acreage. This claim runs from the location monument on which this location notice is posted at the **SE** corner of the claim approximately **1320** feet in a **North** direction from the **South** end line and **660** feet in a **West** direction from the **East** end line. This claim is marked by four monuments, one at each corner of the claim. The location monument on which this notice is posted is situated within Section **13**, Township **9N**, Range **5W**, Gila Salt River Base and Meridian, Arizona. This claim encompasses portions of the following legal subdivision(s) if located by legal subdivision or the following quarter section(s), section(s), Township(s) and Range(s) **E 1/2 of the NW 1/4 of the NE 1/4 of Sec. 13, T9N, R5W**, Gila Salt River Base and Meridian, Arizona. The locality of this claim with reference to some natural object or permanent monument and additional information (if any) concerning its locality are as follows: **The NW corner of the claim is located 2640' North and 660' West of the Center of Sec 13, T9N, R5W; This is the Legacy "Denny's Hideout" Claim.**

AMC458308

The above information is shown on the attached map. DATED AND POSTED on the ground this **1st** day of **September, 2019**.

Locators:

Printed Name Fred Dickinson Signature(s) 

Address: 7815 W. Rock Springs Dr., Peoria, AZ 85383

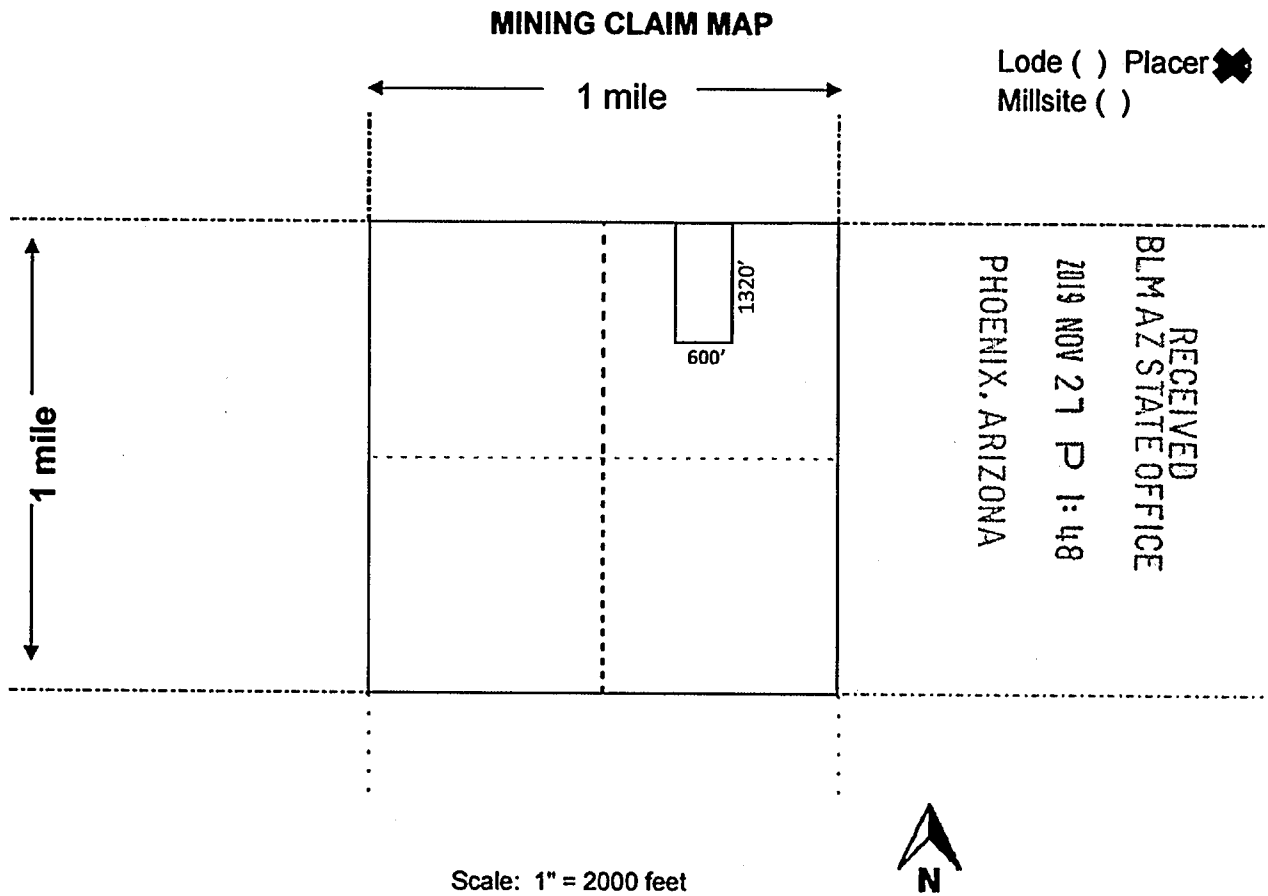

1. The above map depicts the **Dickinson #3** mining claim, which is located in Section(s) **13**, Township **9N**, Range **5W**, Gila and Salt River Base and Meridian, **Yavapai** County, Arizona.

Total claim acreage is **20 Acres**.

2. The type of corner and location monuments used are as follows: **2" Capped PVC, Standing 5' tall.**

3. The bearings and distances in degrees and feet between claim corners and to a public land survey monument are as depicted on the map. **The NW corner of the claim is located 2640' North and 660' West of the Center of Sec 13, T9N, R5W..**

4. If the claim is a placer or millsite claim with exterior limits conforming to legal subdivisions of the public survey, provide a legal description of the claim **The E ½ of the NW ¼ of the NE ¼ of Sec 13, T9N, R5W. of the Gila and Salt River Base and Meridian, Yavapai County, Arizona.**

AHC458308

Date and Time Run:
12/5/2019 11:58:20 AM

Page 1 of 1

**DEPARTMENT OF THE INTERIOR
BUREAU OF LAND MANAGEMENT
Case Recordation**

Geographic Report with Land

Disposition is equal to **AUTHORIZED , CANCELLED , EXPIRED , PENDING , REJECTED , RELINQUISHED ,
WITHDRAWN**
and Meridian Township Range Section is equal to **14 0090N 0050W 013**
and Admin State is equal to **AZ**

**NO WARRANTY IS MADE BY BLM
FOR USE OF THE DATA FOR
PURPOSES NOT INTENDED BY BLM**

DEPARTMENT OF THE INTERIOR
BUREAU OF LAND MANAGEMENT
Case Recordation
Geographic Report with Land

Admin State: AZ
Geo State: AZ

Serial Number	Total Case Acres:	Casetype	Case Disp	Mer	Twp	Rng	Sec	Sur Type	Sur Nr	Suf	Subdivision	Act Pend
AZA 032939	1.000	293200	EXPIRED	14	0090N	0050W	013	FF			PORTION OF;	
AZA 034832	5.000	380913	PENDING					FF			E2;	
AZA 035210	1.000	293200	EXPIRED					FF			PORTIONS OF;	
AZA 036698	20.000	380913	PENDING					FF			NESW;	
AZA 036815	1.000	380913	EXPIRED					FF			E2SESW;	
AZA 036850	18.000	380910	PENDING					FF			E2SW;	
AZA 037334	1.000	380913	AUTHORIZED					ALIQ			NE;	
AZA 037520	1.000	380913	AUTHORIZED					FF			NE;	
AZA 037935	0.250	380913	PENDING					FF			SE	
AZAR 0000110	39.400	285003	AUTHORIZED					ALIQ			E2NE,SWNE,W2SE;	
AZAR 0034626	26.550	286202	AUTHORIZED					ALIQ			E2W2;	

